

API No. <u>42-495-33710</u> Drilling Permit # <u>813658</u> SWR Exception Case/Docket No. _____		<b>RAILROAD COMMISSION OF TEXAS</b> <b>OIL &amp; GAS DIVISION</b> <b>APPLICATION FOR PERMIT TO DRILL, RECOMPLETE, OR RE-ENTER</b> <i>This facsimile W-1 was generated electronically from data submitted to the RRC.</i> <i>A certification of the automated data is available in the RRC's Austin office.</i>				<b>FORM W-1</b> 07/2004 Permit Status: <b>Approved</b>	
1. RRC Operator No. <b>945936</b>		2. Operator's Name (as shown on form P-5, Organization Report) <b>XTO ENERGY INC.</b>			3. Operator Address (include street, city, state, zip): <b>ATTN DEEANN KEMP</b> <b>500 WEST ILLINOIS STE 100</b> <b>MIDLAND, TX 79701-0000</b>		
4. Lease Name <b>UNIVERSITY BLK 20</b>			5. Well No. <b>1307H</b>				
<b>GENERAL INFORMATION</b>							
6. Purpose of filing (mark ALL appropriate boxes): <input checked="" type="checkbox"/> New Drill <input type="checkbox"/> Recompletion <input type="checkbox"/> Reclass <input type="checkbox"/> Field Transfer <input type="checkbox"/> Re-Enter <input checked="" type="checkbox"/> Amended <input type="checkbox"/> Amended as Drilled (BHL) (Also File Form W-1D)							
7. Wellbore Profile (mark ALL appropriate boxes): <input type="checkbox"/> Vertical <input checked="" type="checkbox"/> Horizontal (Also File Form W-1H) <input type="checkbox"/> Directional (Also File Form W-1D) <input type="checkbox"/> Sidetrack							
8. Total Depth <b>12500</b>		9. Do you have the right to develop the minerals under any right-of-way ? <input checked="" type="checkbox"/> Yes <input type="checkbox"/> No		10. Is this well subject to Statewide Rule 36 (hydrogen sulfide area)? <input type="checkbox"/> Yes <input checked="" type="checkbox"/> No			
<b>SURFACE LOCATION AND ACREAGE INFORMATION</b>							
11. RRC District No. <b>08</b>		12. County <b>WINKLER</b>		13. Surface Location <input checked="" type="checkbox"/> Land <input type="checkbox"/> Bay/Estuary <input type="checkbox"/> Inland Waterway <input type="checkbox"/> Offshore			
14. This well is to be located <u>7.6</u> miles in a <u>W</u> direction from <u>Wink</u> which is the nearest town in the county of the well site.							
15. Section <b>13</b>		16. Block <b>20</b>		17. Survey <b>UL</b>		18. Abstract No. <b>A-U14</b>	
				19. Distance to nearest lease line: <b>200</b> ft.		20. Number of contiguous acres in lease, pooled unit, or unitized tract: <b>1381.51</b>	
21. Lease Perpendiculars: <u>5268</u> ft from the <u>NORTH</u> line and <u>1536</u> ft from the <u>EAST</u> line. 22. Survey Perpendiculars: <u>1963</u> ft from the <u>NORTH</u> line and <u>1536</u> ft from the <u>WEST</u> line.							
23. Is this a pooled unit? <input checked="" type="checkbox"/> Yes <input type="checkbox"/> No			24. Unitization Docket No: _____				
25. Are you applying for Substandard Acreage Field? <input type="checkbox"/> Yes (attach Form W-1A) <input checked="" type="checkbox"/> No							
<b>FIELD INFORMATION List all fields of anticipated completion including Wildcat. List one zone per line.</b>							
26. RRC District No.	27. Field No.	28. Field Name (exactly as shown in RRC records)			29. Well Type	30. Completion Depth	
08	71052900	PHANTOM (WOLFCAMP)			Oil Well	12500	
<b>BOTTOMHOLE LOCATION INFORMATION is required for DIRECTIONAL, HORIZONTAL, AND AMENDED AS DRILLED PERMIT APPLICATIONS (see W-1H attachment)</b>							
<b>Remarks</b> [FILER Feb 22, 2016 12:45 PM]: Amending permit for TD only. No other changes.					<b>Certificate:</b> I certify that information stated in this application is true and complete, to the best of my knowledge. <b>Stephanie Rabadue, Regulatory Analyst</b> Name of filer _____ Date submitted <b>Feb 22, 2016</b> <u>(432)6206714</u> <u>Stephanie_Rabadue@xtoenergy.com</u> Phone E-mail Address (OPTIONAL)		
<b>RRC Use Only</b> Data Validation Time Stamp: Feb 23, 2016 9:59 AM( Current Version )							

Permit Status: <b>Approved</b>  <i>The RRC has not approved this application.          Duplication or distribution of information is          at the user's own risk.</i>
---

**RAILROAD COMMISSION OF TEXAS  
OIL & GAS DIVISION**

**APPLICATION FOR PERMIT TO DRILL, RECOMPLETE, OR RE-ENTER**

*This facsimile W-1 was generated electronically from data submitted to the RRC.  
 A certification of the automated data is available in the RRC's Austin office.*

Permit #	813658
Approved Date: Feb 23, 2016	

1. RRC Operator No. <b>945936</b>	2. Operator's Name (exactly as shown on form P-5, Organization Report) <b>XTO ENERGY INC.</b>	3. Lease Name <b>UNIVERSITY BLK 20</b>	4. Well No. <b>1307H</b>
<b>Lateral Drainhole Location Information</b>			
5. Field as shown on Form W-1 <b>PHANTOM (WOLFCAMP) (Field # 71052900, RRC District 08)</b>			
6. Section <b>20</b>	7. Block <b>24</b>	8. Survey <b>UL / A-U21</b>	9. Abstract
		10. County of BHL <b>WINKLER</b>	
11. Terminus Lease Line Perpendiculars <b>200</b> ft. from the <b>South</b> line. and <b>1526</b> ft. from the <b>West</b> line			
12. Terminus Survey Line Perpendiculars <b>200</b> ft. from the <b>South</b> line. and <b>1526</b> ft. from the <b>West</b> line			
13. Penetration Point Lease Line Perpendiculars <b>6052</b> ft. from the <b>North</b> line. and <b>1526</b> ft. from the <b>West</b> line			

## PERMIT TO DRILL, DEEPEN, PLUG BACK, OR RE-ENTER ON A REGULAR OR ADMINISTRATIVE EXCEPTION LOCATION

Page 3 of 5

**RAILROAD COMMISSION OF TEXAS**  
**OIL & GAS DIVISION**

PERMIT TO DRILL, DEEPEN, PLUG BACK, OR RE-ENTER ON A REGULAR OR ADMINISTRATIVE EXCEPTION LOCATION

PERMIT NUMBER <div style="text-align: right;">813658</div>	DATE PERMIT ISSUED OR AMENDED <div style="text-align: center;">Feb 05, 2016</div>	DISTRICT <div style="text-align: center;">* 08</div>
API NUMBER <div style="text-align: right;">42-495-33710</div>	FORM W-1 RECEIVED <div style="text-align: center;">Feb 03, 2016</div>	COUNTY <div style="text-align: center;">WINKLER</div>
TYPE OF OPERATION <div style="text-align: center;">NEW DRILL</div>	WELLBORE PROFILE(S) <div style="text-align: center;">Horizontal</div>	ACRES <div style="text-align: center;">1381.51</div>
OPERATOR <div style="text-align: right;">945936</div> <div style="text-align: center;">XTO ENERGY INC.</div> <div style="text-align: center;">ATTN DEEANN KEMP</div> <div style="text-align: center;">500 WEST ILLINOIS STE 100</div> <div style="text-align: center;">MIDLAND, TX 79701-0000</div>		NOTICE This permit and any allowable assigned may be revoked if payment for fee(s) submitted to the Commission is not honored. <b>District Office Telephone No:</b> <div style="text-align: center;">(432) 684-5581</div>
LEASE NAME <div style="text-align: center;">UNIVERSITY BLK 20</div>		WELL NUMBER <div style="text-align: center;">1307H</div>
LOCATION <div style="text-align: center;">7.6 miles W direction from WINK</div>		TOTAL DEPTH <div style="text-align: center;">12700</div>
Section, Block and/or Survey <div style="display: flex; justify-content: space-between;"> <div>SECTION ◀ 13</div> <div>BLOCK ◀ 20</div> <div>ABSTRACT ◀ U14</div> </div> <div style="display: flex; justify-content: space-between;"> <div>SURVEY ◀ UL</div> <div></div> <div></div> </div>		
DISTANCE TO SURVEY LINES <div style="text-align: center;">1963 ft. NORTH    1536 ft. WEST</div>		DISTANCE TO NEAREST LEASE LINE <div style="text-align: center;">200 ft.</div>
DISTANCE TO LEASE LINES <div style="text-align: center;">5268 ft. NORTH    1536 ft. EAST</div>		DISTANCE TO NEAREST WELL ON LEASE <div style="text-align: center;">See FIELD(s) Below</div>
FIELD(s) and LIMITATIONS: <div style="text-align: center;">* SEE FIELD DISTRICT FOR REPORTING PURPOSES *</div>		
<div style="display: flex; justify-content: space-between;"> <div>                     FIELD NAME                      LEASE NAME                 </div> <div>                     ACRES                      NEAREST LEASE                 </div> <div>                     DEPTH                      NEAREST LEASE                 </div> <div>                     WELL #                      NEAREST WE                 </div> <div>                     DIST                 </div> </div>		
This well must comply to the new SWR 3.13 requirements concerning the isolation of any potential flow zones and zones with corrosive formation fluids. See approved permit for those formations that have been identified for the county in which you are drilling the well in.		

**RAILROAD COMMISSION OF TEXAS  
OIL & GAS DIVISION  
SWR #13 Formation Data**

**WINKLER (495) County**

Formation	Shallow Top	Deep Top	Remarks	Geological Order	Effective Date
RUSTLER	725	725	possible flow; possible usable quality water	1	12/17/2013
COLBY-QUEEN	2,900	3,200		2	12/17/2013
YATES	2,280	3,200		3	12/17/2013
QUEEN-SEVEN RIVERS	2,700	3,400		4	12/17/2013
SAN ANDRES	3,600	4,400	high flows, H2S, corrosive	5	12/17/2013
HOLT	4,500	4,800		6	12/17/2013
DELAWARE	4,300	5,000		7	12/17/2013
GLORIETA	4,900	5,600		8	12/17/2013
CLEARFORK	4,750	6,200		9	12/17/2013
WICHITA ALBANY	6,600	6,850		10	12/17/2013
BRUSHY CANYON	7,300	7,300		11	12/17/2013
CHERRY CANYON	6,000	7,800		12	12/17/2013
CANYON	8,400	8,400		13	12/17/2013
BONE SPRINGS	9,000	9,800		14	12/17/2013
MONTOYA	10,300	10,300		15	12/17/2013
WADDELL	11,000	11,000		16	12/17/2013
WOLFCAMP	7,600	12,400		17	12/17/2013
ATOKA	12,900	12,900		18	12/17/2013
STRAWN	8,100	14,800		19	12/17/2013
PENNSYLVANIAN	8,000	15,500		20	12/17/2013
MISSISSIPPIAN	10,200	17,300		21	12/17/2013
DEVONIAN	7,900	17,800		22	12/17/2013
SILURIAN	8,500	18,000		23	12/17/2013
FUSSELMAN	9,700	18,800		24	12/17/2013
ELLENBURGER	9,500	21,400		25	12/17/2013

The above list may not be all inclusive, and may also include formations that do not intersect all wellbores. Formation "TOP" information listed reflects an estimated range based on geologic variances across the county. To clarify, the "Deep Top" is not the bottom of the formation; it is the deepest depth at which the "TOP" of the formation has been or might be encountered. This is a dynamic list subject to updates and revisions. It is the operator's responsibility to make sure that at the time of spudding the well the most current list is being referenced. Refer to the RRC website at the following address for the most recent information.  
<http://www.rrc.state.tx.us/oil-gas/compliance-enforcement/rule-13-geologic-formation-info>



0 1000' 2000'  
1" = 2000 FEET

SURFACE HOLE LOCATION  
UNIVERSITY BLK 20 #1307H  
ELEV. 2813'

UNIVERSITY LAND  
SECTION 14, BLOCK 20

UNIVERSITY LAND  
SECTION 23, BLOCK 20

LESSOR TABLE:

TRACT NO.	LESSOR	CALLED ACREAGE
1	State of Texas	140.152
2	State of Texas	600.656
3	State of Texas	640.700
	TOTAL	1381.508

UNIVERSITY LAND  
SECTION 26, BLOCK 20

UNIVERSITY LAND  
SECTION 12, BLOCK 20

UNIVERSITY LAND  
SECTION 7, BLOCK 21

UNIVERSITY LAND  
SECTION 18, BLOCK 21

UNIVERSITY LAND  
SECTION 13, BLOCK 20

UNIVERSITY LAND  
SECTION 19, BLOCK 21

UNIVERSITY LAND  
SECTION 24, BLOCK 20

UNIVERSITY LAND  
SECTION 30, BLOCK 21

UNIVERSITY LAND  
SECTION 25, BLOCK 20

XTO ENERGY INC.  
A PORTION OF THE  
BLOCK 20 LEASE  
(1381.508 CALLED ACRES)

GENERAL NOTES

- COORDINATES SHOWN ARE BASED ON TEXAS PLANE COORDINATE SYSTEM OF NAD 27, TEXAS CENTRAL ZONE 4203
- VERTICAL DATUM IS NAVD 88
- LATITUDE AND LONGITUDE ARE NAD 27 AS SHOWN
- AREA, DISTANCES, AND COORDINATES ARE "GRID".
- UNITS ARE UNITED STATES SURVEY FOOT.
- ALL LEASE AND TRACT INFORMATION SHOWN HERE ON IS DONE SO BY LIMITED DEED RECORD INFORMATION ONLY. ALL ACREAGES SHOWN ARE BY DEED AND LEASE CALL, EXCEPT WHERE NOTED. THIS IS NOT IN ANY WAY A "BOUNDARY SURVEY".

DRIVING DIRECTIONS TO LOCATION:

FROM WINK, HEAD WEST ON FARM TO MARKET 1232 FOR 1.5 MILES. THEN TURN LEFT (WEST) ONTO COUNTY ROAD 201 FOR 6.8 MILES AND TURN LEFT (SOUTH) ON LEASE ROAD. HEAD SOUTH ON LEASE ROAD FOR 0.4 MILES AND TURN LEFT (EAST) ON LEASE ROAD. HEAD EAST ON LEASE ROAD FOR 0.3 MILES AND THE LOCATION WILL BE APPROXIMATELY 600 FEET ON THE LEFT (NORTH).

WELL LOCATION INFORMATION:

SURFACE HOLE LOCATION:

NAD 83, TEXAS CENTRAL ZONE COORD'S  
Y = 10,603,812.11, X = 1,378,690.93  
LAT: N 31.72636°, LONG: W 103.28585°  
SHL: 1536' FWL & 1963' FNL  
SHL: 1536' FWLL & 5268' FNLL

NAD 27, TEXAS CENTRAL ZONE COORD'S  
Y = 761,235.91, X = 1,082,226.69  
LAT: N 31.72624°, LONG: W 103.28540°

TP1/PP LOCATION:

NAD 83, TEXAS CENTRAL ZONE COORD'S  
Y = 10,603,056.65, X = 1,378,901.10  
LAT: N 31.72430°, LONG: W 103.28511°  
TP1/PP: 1526' FWLL & 6052' FNLL

NAD 27, TEXAS CENTRAL ZONE COORD'S  
Y = 760,480.46, X = 1,082,436.85  
LAT: N 31.72418°, LONG: W 103.28466°

BOTTOM HOLE LOCATION/TP2:

NAD 83, TEXAS CENTRAL ZONE COORD'S  
Y = 10,595,735.68, X = 1,381,040.31  
LAT: N 31.70434°, LONG: W 103.27761°  
BHL/TP2: 200' FSL & 1526' FWL  
BHL/TP2: 200' FSLL & 1526' FWLL

NAD 27, TEXAS CENTRAL ZONE COORD'S  
Y = 753,159.59, X = 1,084,575.96  
LAT: N 31.70421°, LONG: W 103.27716°

I HEREBY STATE THAT THIS PLAT  
SHOWS THE SUBJECT SURFACE  
LOCATION AS STAKED ON THE GROUND.

JOHN E. KOWALIK  
REGISTERED PROFESSIONAL LAND SURVEYOR  
STATE OF TEXAS NO. 6408

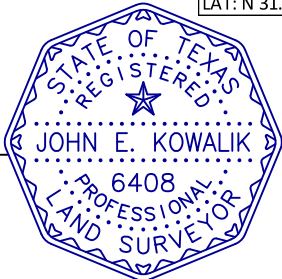

PLAT OF:  
A WELL LOCATION FOR:  
XTO ENERGY INC.

UNIVERSITY BLK 20 #1307H

SITUATED IN THE UNIVERSITY LAND, SECTION 13, BLOCK 20, AND UNIVERSITY LAND, SECTION 24, BLOCK 20 BEING APPROXIMATELY 7.6 MILES WEST OF WINK IN WINKLER COUNTY, TEXAS.

DATE: 01/22/2016  
DRAWN BY: BLC/AI  
CHECKED BY: AP/CH/JK  
FIELD CREW: DC/BK  
PROJECT NO: 2015121235  
SCALE: 1" = 2000'  
SHEET: 1  
REVISION: 1

**FRANK**  
SURVEYING COMPANY INC

550 Bailey Ave., 205 - Fort Worth, TX 76107  
Ph: 817.349.9800 - Fax: 979.732.5271  
TBPLS Firm No. 10193887  
www.franksurveying.com  
LAND SURVEYING/ENERGY/GIS SERVICES

© COPYRIGHT 2014 - ALL RIGHTS RESERVED