

|  |                        |  |   |  |  |  |
|--|------------------------|--|---|--|--|--|
| API No. <u>42-475-37117</u><br>Drilling Permit # <u>817374</u><br>SWR Exception Case/Docket No. _____  |                        | <b>RAILROAD COMMISSION OF TEXAS</b><br><b>OIL &amp; GAS DIVISION</b><br><b>APPLICATION FOR PERMIT TO DRILL, RECOMPLETE, OR RE-ENTER</b><br><i>This facsimile W-1 was generated electronically from data submitted to the RRC.</i><br><i>A certification of the automated data is available in the RRC's Austin office.</i> |   |  | <b>FORM W-1</b> 07/2004<br>Permit Status: <b>Approved</b>                                |  |
| 1. RRC Operator No.<br><u>429574</u>   |                        | 2. Operator's Name (as shown on form P-5, Organization Report)<br><u>JAGGED PEAK ENERGY LLC</u>  |   | 3. Operator Address (include street, city, state, zip):<br><u>1125 17TH STREET SUITE 2400</u><br><u>DENVER, CO 80202-0000</u>  |  |  |
| 4. Lease Name<br><u>RK-UTL 3031B-17</u>  |                        | 5. Well No.<br><u>1H</u>   |   |  |  |  |
| <b>GENERAL INFORMATION</b>   |                        |  |   |  |  |  |
| 6. Purpose of filing (mark ALL appropriate boxes):<br><div style="display: flex; justify-content: space-between;"> <span><input checked="" type="checkbox"/> New Drill</span> <span><input type="checkbox"/> Recompletion</span> <span><input type="checkbox"/> Reclass</span> <span><input type="checkbox"/> Field Transfer</span> <span><input type="checkbox"/> Re-Enter</span> </div> <div style="display: flex; justify-content: space-between;"> <span><input type="checkbox"/> Amended</span> <span><input type="checkbox"/> Amended as Drilled (BHL) (Also File Form W-1D)</span> </div> |                        |  |   |  |  |  |
| 7. Wellbore Profile (mark ALL appropriate boxes):<br><div style="display: flex; justify-content: space-between;"> <span><input type="checkbox"/> Vertical</span> <span><input checked="" type="checkbox"/> Horizontal (Also File Form W-1H)</span> <span><input type="checkbox"/> Directional (Also File Form W-1D)</span> <span><input type="checkbox"/> Sidetrack</span> </div>  |                        |  |   |  |  |  |
| 8. Total Depth<br><u>15000</u>   |                        | 9. Do you have the right to develop the minerals under any right-of-way?<br><input checked="" type="checkbox"/> Yes <input type="checkbox"/> No  |   | 10. Is this well subject to Statewide Rule 36 (hydrogen sulfide area)?<br><input checked="" type="checkbox"/> Yes <input type="checkbox"/> No                                    |  |  |
| <b>SURFACE LOCATION AND ACREAGE INFORMATION</b>  |                        |  |   |  |  |  |
| 11. RRC District No.<br><u>08</u>  |                        | 12. County<br><u>WARD</u>  |   | 13. Surface Location<br><input checked="" type="checkbox"/> Land <input type="checkbox"/> Bay/Estuary <input type="checkbox"/> Inland Waterway <input type="checkbox"/> Offshore |  |  |
| 14. This well is to be located <u>7.9</u> miles in a <u>SW</u> direction from <u>WINK</u> which is the nearest town in the county of the well site.  |                        |  |   |  |  |  |
| 15. Section<br><u>11</u>   | 16. Block<br><u>17</u> | 17. Survey<br><u>UL</u>  | 18. Abstract No.<br><u>A-U50</u>  | 19. Distance to nearest lease line:<br><u>200</u> ft.  | 20. Number of contiguous acres in lease, pooled unit, or unitized tract:<br><u>640.7</u> |  |
| 21. Lease Perpendiculars: <u>330</u> ft from the <u>S (OFFLEASE)</u> line and <u>520</u> ft from the <u>W (OFFLEASE)</u> line.<br>22. Survey Perpendiculars: <u>330</u> ft from the <u>S (OFFLEASE)</u> line and <u>520</u> ft from the <u>W (OFFLEASE)</u> line.  |                        |  |   |  |  |  |
| 23. Is this a pooled unit? <input checked="" type="checkbox"/> Yes <input type="checkbox"/> No   |                        | 24. Unitization Docket No: _____   |   | 25. Are you applying for Substandard Acreage Field? <input type="checkbox"/> Yes (attach Form W-1A) <input checked="" type="checkbox"/> No                                       |  |  |
| <b>FIELD INFORMATION</b> List all fields of anticipated completion including Wildcat. List one zone per line.  |                        |  |   |  |  |  |
| 26. RRC District No.   | 27. Field No.          | 28. Field Name (exactly as shown in RRC records)   | 29. Well Type   | 30. Completion Depth   | 31. Distance to Nearest Well in this Reservoir   |  |
| 08   | 71052900               | PHANTOM (WOLFCAMP)   | Oil or Gas Well   | 15000  | 0.00   |  |
|  |                        |  |   |  |  |  |
|  |                        |  |   |  |  |  |
|  |                        |  |   |  |  |  |
| <b>BOTTOMHOLE LOCATION INFORMATION</b> is required for DIRECTIONAL, HORIZONTAL, AND AMENDED AS DRILLED PERMIT APPLICATIONS (see W-1H attachment)   |                        |  |   |  |  |  |
| <b>Remarks</b><br>[RRC STAFF Aug 1, 2016 5:26 PM]: Added abstract information for the SHL and the BHL.   |                        |  | <b>Certificate:</b><br>I certify that information stated in this application is true and complete, to the best of my knowledge.<br><br><div style="display: flex; justify-content: space-between;"> <div> <u>Mike Paluso</u><br/>           Name of filer         </div> <div> <u>Jul 28, 2016</u><br/>           Date submitted         </div> </div> <div style="display: flex; justify-content: space-between; margin-top: 10px;"> <div> <u>(512)3278111</u><br/>           Phone         </div> <div> <u>mpaluso@msmtx.com</u><br/>           E-mail Address (OPTIONAL)         </div> </div> |  |  |  |
| <b>RRC Use Only</b> Data Validation Time Stamp:    Aug 2, 2016 10:28 AM( Current Version )   |                        |  |   |  |  |  |

|   |          |
|---|----------|
| Permit Status:  | Approved |
| <i>The RRC has not approved this application.<br/>         Duplication or distribution of information is<br/>         at the user's own risk.</i> |          |

**RAILROAD COMMISSION OF TEXAS  
OIL & GAS DIVISION**

**Form W-1H.** 07/2004  
**Supplemental Horizontal Well Information**

**APPLICATION FOR PERMIT TO DRILL, RECOMPLETE, OR RE-ENTER**

*This facsimile W-1 was generated electronically from data submitted to the RRC.  
 A certification of the automated data is available in the RRC's Austin office.*

|                |              |
|----------------|--------------|
| Permit #       | 817374       |
| Approved Date: | Aug 02, 2016 |

|                               |  |                                  |                   |
|-------------------------------|--|----------------------------------|-------------------|
| 1. RRC Operator No.<br>429574 | 2. Operator's Name (exactly as shown on form P-5, Organization Report)<br>JAGGED PEAK ENERGY LLC | 3. Lease Name<br>RK-UTL 3031B-17 | 4. Well No.<br>1H |
|-------------------------------|--|----------------------------------|-------------------|

**Lateral Drainhole Location Information**

|                               |  |
|-------------------------------|--|
| 5. Field as shown on Form W-1 | PHANTOM (WOLFCAMP) (Field # 71052900, RRC District 08) |
|-------------------------------|--|

|                  |                |                         |             |                           |
|------------------|----------------|-------------------------|-------------|---------------------------|
| 6. Section<br>31 | 7. Block<br>17 | 8. Survey<br>UL / A-U70 | 9. Abstract | 10. County of BHL<br>WARD |
|------------------|----------------|-------------------------|-------------|---------------------------|

|   |   |  |  |  |
|---|---|--|--|--|
| 11. Terminus Lease Line Perpendiculars          | 330 ft. from the SOUTH line. and 200 ft. from the WEST line |  |  |  |
| 12. Terminus Survey Line Perpendiculars         | 330 ft. from the SOUTH line. and 200 ft. from the WEST line |  |  |  |
| 13. Penetration Point Lease Line Perpendiculars | 330 ft. from the SOUTH line. and 200 ft. from the EAST line |  |  |  |

**RAILROAD COMMISSION OF TEXAS**  
**OIL & GAS DIVISION**

PERMIT TO DRILL, DEEPEN, PLUG BACK, OR RE-ENTER ON A REGULAR OR ADMINISTRATIVE EXCEPTION LOCATION

|  |  |  |
|--|--|--|
| PERMIT NUMBER<br><b>817374</b>   | DATE PERMIT ISSUED OR AMENDED<br><b>Aug 02, 2016</b> | DISTRICT<br><b>* 08</b>  |
| API NUMBER<br><b>42-475-37117</b>  | FORM W-1 RECEIVED<br><b>Jul 28, 2016</b>             | COUNTY<br><b>WARD</b>  |
| TYPE OF OPERATION<br><b>NEW DRILL</b>  | WELLBORE PROFILE(S)<br><b>Horizontal</b>             | ACRES<br><b>640.7</b>  |
| OPERATOR<br><b>JAGGED PEAK ENERGY LLC</b><br><b>1125 17TH STREET SUITE 2400</b><br><b>DENVER, CO 80202-0000</b>  |  | NOTICE<br>This permit and any allowable assigned may be<br>revoked if payment for fee(s) submitted to the<br>Commission is not honored.<br><b>District Office Telephone No:</b><br><b>(432) 684-5581</b> |
| LEASE NAME<br><b>RK-UTL 3031B-17</b>   |  | WELL NUMBER<br><b>1H</b>   |
| LOCATION<br><b>7.9 miles SW direction from WINK</b>  |  | TOTAL DEPTH<br><b>15000</b>  |
| Section, Block and/or Survey<br>SECTION ◀ <b>11</b> BLOCK ◀ <b>17</b> ABSTRACT ◀ <b>U50</b><br>SURVEY ◀ <b>UL</b>  |  |  |
| DISTANCE TO SURVEY LINES<br><b>330 ft. S (OFFLEASE) 520 ft. W (OFFLEASE)</b>   |  | DISTANCE TO NEAREST LEASE LINE<br><b>200 ft.</b>   |
| DISTANCE TO LEASE LINES<br><b>330 ft. S (OFFLEASE) 520 ft. W (OFFLEASE)</b>  |  | DISTANCE TO NEAREST WELL ON LEASE<br><b>See FIELD(s) Below</b>   |
| FIELD(s) and LIMITATIONS:<br><p align="center"><b>* SEE FIELD DISTRICT FOR REPORTING PURPOSES *</b></p>  |  |  |
| FIELD NAME<br>LEASE NAME   | ACRES<br>NEAREST LEASE                               | DEPTH<br>NEAREST WE  |
| -----  | -----  | -----  |
| <b>PHANTOM (WOLFCAMP)</b>  | <b>640.70</b>  | <b>15,000</b>  |
| <b>RK-UTL 3031B-17</b>   | <b>200</b>   | <b>0</b>   |
| -----  |  |  |
| WELLBORE PROFILE(s) FOR FIELD: <b>Horizontal</b>   |  |  |
| -----  |  |  |
| RESTRICTIONS: This is a hydrogen sulfide field. Hydrogen Sulfide Fields with perforations must be isolated and tested per State Wide Rule 36 and a Form H-9 filed with the district office. Fields with SWR 10 authority to downhole commingle must be isolated and tested individually prior to commingling production.   |  |  |
| Lateral: TH1<br>Penetration Point Location<br>Lease Lines:           330.0 F SOUTH L<br>200.0 F EAST L<br>Terminus Location<br>BH County: WARD<br>Section: 31                      Block: 17                      Abstract:<br>Survey: UL / A-U70<br>Lease Lines:           330.0 F SOUTH L<br>200.0 F WEST L<br>Survey Lines:       330.0 F SOUTH L<br>200.0 F WEST L |  |  |
| <b>THE FOLLOWING RESTRICTIONS APPLY TO ALL FIELDS</b>  |  |  |

**RAILROAD COMMISSION OF TEXAS**  
**OIL & GAS DIVISION**

PERMIT TO DRILL, DEEPEN, PLUG BACK, OR RE-ENTER ON A REGULAR OR ADMINISTRATIVE EXCEPTION LOCATION

|  |  |  |
|--|--|--|
| PERMIT NUMBER<br><b>817374</b>   | DATE PERMIT ISSUED OR AMENDED<br><b>Aug 02, 2016</b> | DISTRICT<br><b>* 08</b>  |
| API NUMBER<br><b>42-475-37117</b>  | FORM W-1 RECEIVED<br><b>Jul 28, 2016</b>             | COUNTY<br><b>WARD</b>  |
| TYPE OF OPERATION<br><b>NEW DRILL</b>  | WELLBORE PROFILE(S)<br><b>Horizontal</b>             | ACRES<br><b>640.7</b>  |
| OPERATOR<br><b>JAGGED PEAK ENERGY LLC</b><br><b>1125 17TH STREET SUITE 2400</b><br><b>DENVER, CO 80202-0000</b>  |  | NOTICE<br>This permit and any allowable assigned may be<br>revoked if payment for fee(s) submitted to the<br>Commission is not honored.<br><b>District Office Telephone No:</b><br><b>(432) 684-5581</b> |
| LEASE NAME<br><b>RK-UTL 3031B-17</b>   |  | WELL NUMBER<br><b>1H</b>   |
| LOCATION<br><b>7.9 miles SW direction from WINK</b>  |  | TOTAL DEPTH<br><b>15000</b>  |
| Section, Block and/or Survey<br>SECTION ◀ <b>11</b> BLOCK ◀ <b>17</b> ABSTRACT ◀ <b>U50</b><br>SURVEY ◀ <b>UL</b>  |  |  |
| DISTANCE TO SURVEY LINES<br><b>330 ft. S (OFFLEASE) 520 ft. W (OFFLEASE)</b>   |  | DISTANCE TO NEAREST LEASE LINE<br><b>200 ft.</b>   |
| DISTANCE TO LEASE LINES<br><b>330 ft. S (OFFLEASE). 520 ft. W (OFFLEASE)</b>   |  | DISTANCE TO NEAREST WELL ON LEASE<br><b>See FIELD(s) Below</b>   |
| FIELD(s) and LIMITATIONS:<br><p align="center"><b>* SEE FIELD DISTRICT FOR REPORTING PURPOSES *</b></p>  |  |  |
| FIELD NAME<br>LEASE NAME   | ACRES<br>NEAREST LEASE                               | DEPTH<br>NEAREST WE  |
| This well shall be completed and produced in compliance with applicable special field or statewide spacing and density rules. If this well is to be used for brine mining, underground storage of liquid hydrocarbons in salt formations, or underground storage of gas in salt formations, a permit for that specific purpose must be obtained from Environmental Services prior to construction, including drilling, of the well in accordance with Statewide Rules 81, 95, and 97.<br>This well must comply to the new SWR 3.13 requirements concerning the isolation of any potential flow zones and zones with corrosive formation fluids. See approved permit for those formations that have been identified for the county in which you are drilling the well in. |  |  |

**RAILROAD COMMISSION OF TEXAS  
OIL & GAS DIVISION  
SWR #13 Formation Data**

**WARD (475) County**

| Formation         | Shallow Top | Deep Top | Remarks                    | Geological Order | Effective Date |
|-------------------|-------------|----------|----------------------------|------------------|----------------|
| RUSTLER           | 1,700       | 1,700    |                            | 1                | 12/17/2013     |
| YATES             | 2,000       | 2,800    |                            | 2                | 12/17/2013     |
| SEVEN RIVERS      | 2,375       | 2,375    |                            | 3                | 12/17/2013     |
| QUEEN             | 2,200       | 3,200    |                            | 4                | 12/17/2013     |
| GLORIETA          | 3,900       | 4,000    |                            | 5                | 12/17/2013     |
| SAN ANDRES        | 2,000       | 4,500    | high flows, H2S, corrosive | 6                | 12/17/2013     |
| HOLT              | 4,600       | 4,800    |                            | 7                | 12/17/2013     |
| CLEARFORK         | 4,500       | 5,000    |                            | 8                | 12/17/2013     |
| DELAWARE          | 2,300       | 5,000    |                            | 9                | 12/17/2013     |
| TUBB              | 4,600       | 5,300    |                            | 10               | 12/17/2013     |
| WICHITA<br>ALBANY | 6,000       | 6,200    |                            | 11               | 12/17/2013     |
| CHERRY<br>CANYON  | 4,800       | 7,800    |                            | 12               | 12/17/2013     |
| WADDELL           | 7,600       | 9,700    |                            | 13               | 12/17/2013     |
| BONE SPRINGS      | 4,700       | 9,800    |                            | 14               | 12/17/2013     |
| WOLFCAMP          | 6,000       | 12,750   |                            | 15               | 12/17/2013     |
| MONTOYA           | 14,500      | 14,500   |                            | 16               | 12/17/2013     |
| PENNSYLVANIAN     | 7,500       | 14,900   |                            | 17               | 12/17/2013     |
| ATOKA             | 12,000      | 15,000   |                            | 18               | 12/17/2013     |
| FUSSELMAN         | 6,400       | 17,500   |                            | 19               | 12/17/2013     |
| DEVONIAN          | 6,200       | 17,800   |                            | 20               | 12/17/2013     |
| ELLENBURGER       | 7,900       | 20,800   |                            | 21               | 12/17/2013     |

The above list may not be all inclusive, and may also include formations that do not intersect all wellbores. Formation "TOP" information listed reflects an estimated range based on geologic variances across the county. To clarify, the "Deep Top" is not the bottom of the formation; it is the deepest depth at which the "TOP" of the formation has been or might be encountered. This is a dynamic list subject to updates and revisions. It is the operator's responsibility to make sure that at the time of spudding the well the most current list is being referenced. Refer to the RRC website at the following address for the most recent information.  
<http://www.rrc.texas.gov/oil-gas/compliance-enforcement/rule-13-geologic-formation-info>

**RAILROAD COMMISSION OF TEXAS  
OIL & GAS DIVISION  
SWR #13 Formation Data**

**WARD (475) County**

| Formation         | Shallow Top | Deep Top | Remarks                    | Geological Order | Effective Date |
|-------------------|-------------|----------|----------------------------|------------------|----------------|
| RUSTLER           | 1,700       | 1,700    |                            | 1                | 12/17/2013     |
| YATES             | 2,000       | 2,800    |                            | 2                | 12/17/2013     |
| SEVEN RIVERS      | 2,375       | 2,375    |                            | 3                | 12/17/2013     |
| QUEEN             | 2,200       | 3,200    |                            | 4                | 12/17/2013     |
| GLORIETA          | 3,900       | 4,000    |                            | 5                | 12/17/2013     |
| SAN ANDRES        | 2,000       | 4,500    | high flows, H2S, corrosive | 6                | 12/17/2013     |
| HOLT              | 4,600       | 4,800    |                            | 7                | 12/17/2013     |
| CLEARFORK         | 4,500       | 5,000    |                            | 8                | 12/17/2013     |
| DELAWARE          | 2,300       | 5,000    |                            | 9                | 12/17/2013     |
| TUBB              | 4,600       | 5,300    |                            | 10               | 12/17/2013     |
| WICHITA<br>ALBANY | 6,000       | 6,200    |                            | 11               | 12/17/2013     |
| CHERRY<br>CANYON  | 4,800       | 7,800    |                            | 12               | 12/17/2013     |
| WADDELL           | 7,600       | 9,700    |                            | 13               | 12/17/2013     |
| BONE SPRINGS      | 4,700       | 9,800    |                            | 14               | 12/17/2013     |
| WOLFCAMP          | 6,000       | 12,750   |                            | 15               | 12/17/2013     |
| MONTOYA           | 14,500      | 14,500   |                            | 16               | 12/17/2013     |
| PENNSYLVANIAN     | 7,500       | 14,900   |                            | 17               | 12/17/2013     |
| ATOKA             | 12,000      | 15,000   |                            | 18               | 12/17/2013     |
| FUSSELMAN         | 6,400       | 17,500   |                            | 19               | 12/17/2013     |
| DEVONIAN          | 6,200       | 17,800   |                            | 20               | 12/17/2013     |
| ELLENBURGER       | 7,900       | 20,800   |                            | 21               | 12/17/2013     |

The above list may not be all inclusive, and may also include formations that do not intersect all wellbores. Formation "TOP" information listed reflects an estimated range based on geologic variances across the county. To clarify, the "Deep Top" is not the bottom of the formation; it is the deepest depth at which the "TOP" of the formation has been or might be encountered. This is a dynamic list subject to updates and revisions. It is the operator's responsibility to make sure that at the time of spudding the well the most current list is being referenced. Refer to the RRC website at the following address for the most recent information.  
<http://www.rrc.texas.gov/oil-gas/compliance-enforcement/rule-13-geologic-formation-info>

## GROUNDWATER PROTECTION DETERMINATION

Form GW-2



## Groundwater Advisory Unit

**Date Issued:** 28 July 2016**GAU Number:** 158019**Attention:** JAGGED PEAK ENERGY LLC  
1125 17TH STREET SUITE  
DENVER, CO 80202**Operator No.:** 429574**API Number:**  
**County:** WARD  
**Lease Name:** RK-UTL 3031B-17  
**Lease Number:**  
**Well Number:** 1H  
**Total Vertical Depth:** 15000  
**Latitude:** 31.647825  
**Longitude:** -103.205941  
**Datum:** NAD27**Purpose:** New Drill**Location:** Survey-UL; Abstract-U50; Block-17; Section-11

To protect usable-quality groundwater at this location, the Groundwater Advisory Unit of the Railroad Commission of Texas recommends:

The interval from the land surface to the base of the Allurossa, which is estimated to occur at a depth of 875 feet, must be protected.

Please send Gamma Ray/Porosity log of this well when it is available.

This recommendation is applicable for all wells drilled in this Section 11 on this Lease and in this County.

Note: Unless stated otherwise, this recommendation is intended to apply only to the subject well and not for area-wide use. This recommendation is for normal drilling, production, and plugging operations only. It does not apply to saltwater disposal operation into a nonproductive zone (RRC Form W-14).

This determination is based on information provided when the application was submitted on 07/28/2016. If the location information has changed, you must contact the Groundwater Advisory Unit, and submit a new application if necessary. If you have questions, please contact us at 512-463-2741 or gau@rrc.texas.gov.

Groundwater Advisory Unit, Oil and Gas Division



Block 17, University Lands Survey

Driving Directions To Location:  
From the intersection of Highway 115 and Farm To Market Road 1232 in Wink, Texas;  
Drive South on Hwy 115 5.1 miles to Little Joe Rd.;  
Turn right (West) on to Little Joe Rd., drive 3.7 miles to dirt road at Lat: 31°39'42.12", Long: 103°12'25.29";  
Turn left (South) on to dirt road, drive 1.0 miles to Lat: 31°38'52.62", Long: 103°12'43.50";  
Location is left (East) 1,780 feet.

Bottom Hole Location (BHL)/  
Last Take Point (LTP)  
GRID N: 729025.820  
GRID E: 1095742.013  
NAD'83 Lat/Long  
Lat: +31°38'19.774" N  
Lon: -103°14'22.865" W  
Lat: +31.638826° N  
Lon: -103.239685° W

Penetration Point (PP)/  
First Take Point (FTP)  
GRID N: 731874.451  
GRID E: 1105496.162  
NAD'83 Lat/Long  
Lat: +31°38'50.465" N  
Lon: -103°12'30.918" W  
Lat: +31.647351° N  
Lon: -103.208588° W

Surface Hole Location (SHL)  
GRID N: 732076.451  
GRID E: 1106187.245  
NAD'83 Lat/Long  
Lat: +31°38'52.640" N  
Lon: -103°12'22.986" W  
Lat: +31.647956° N  
Lon: -103.206385° W

SHL-FTP/PP  
N 73°42'24" E  
720.00'

RK-UTL 3031B-17-1H  
EL.  
2725

N 73°42'05" E 5280.01'

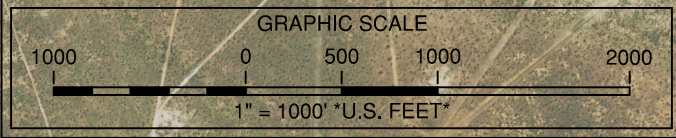

Note: Well is located 7.9 miles Southwest of the city of Wink, Texas.  
Note: Survey Reconstruction filed in the Office of Pennell & Marlowe Land Surveyors, Inc.  
Note: Coordinates shown herein are on The Texas Coordinate System of 1927, Central Zone.  
Note: Bearings and distances are based on The Texas Coordinate System of 1927, Central Zone.  
Note: This plat is NOT a boundary survey and should NOT be used to convey interest in any real property.

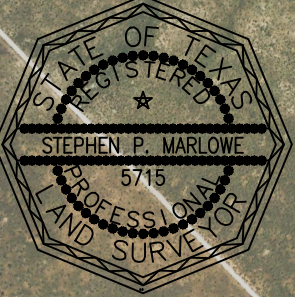
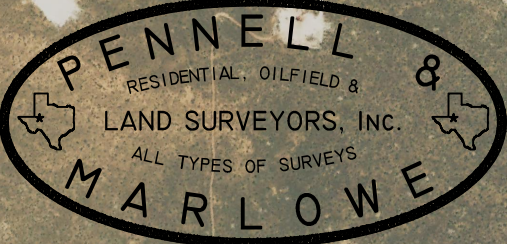

USGS Quadrangle Sheet: Wink South, Tex.  
Railroad Commission Permit Plat

JAGGED PEAK ENERGY  
RK-UTL 3031B-17 #1H  
330' FROM SOUTH LINE  
520' FROM WEST LINE  
RK-UTL 3031B-17 Lease  
640.9 Acres being the S/2 of  
Sections 30 & 31, Block 17  
University Lands Survey  
Winkler County, Texas  
Ward County, Texas  
Scale: 1" = 1000'

June 29, 2016

160629B1-NRL