

API No. <u>42-461-40592</u> Drilling Permit # <u>826301</u> SWR Exception Case/Docket No. _____		<b>RAILROAD COMMISSION OF TEXAS</b> <b>OIL &amp; GAS DIVISION</b> <b>APPLICATION FOR PERMIT TO DRILL, RECOMPLETE, OR RE-ENTER</b> <i>This facsimile W-1 was generated electronically from data submitted to the RRC.</i> <i>A certification of the automated data is available in the RRC's Austin office.</i>				<b>FORM W-1</b> 07/2004 Permit Status: <b>Approved</b>	
1. RRC Operator No. <b>416330</b>		2. Operator's Name (as shown on form P-5, Organization Report) <b>HUNT OIL COMPANY</b>		3. Operator Address (include street, city, state, zip): <b>1900 NORTH AKARD STREET</b> <b>DALLAS, TX 75201-2300</b>			
4. Lease Name <b>UNIVERSITY 3-35</b>		5. Well No. <b>102HB</b>					
<b>GENERAL INFORMATION</b>							
6. Purpose of filing (mark ALL appropriate boxes): <input checked="" type="checkbox"/> New Drill <input type="checkbox"/> Recompletion <input type="checkbox"/> Reclass <input type="checkbox"/> Field Transfer <input type="checkbox"/> Re-Enter <input type="checkbox"/> Amended <input type="checkbox"/> Amended as Drilled (BHL) (Also File Form W-1D)							
7. Wellbore Profile (mark ALL appropriate boxes): <input type="checkbox"/> Vertical <input checked="" type="checkbox"/> Horizontal (Also File Form W-1H) <input type="checkbox"/> Directional (Also File Form W-1D) <input type="checkbox"/> Sidetrack							
8. Total Depth <b>8422</b>		9. Do you have the right to develop the minerals under any right-of-way ? <input checked="" type="checkbox"/> Yes <input type="checkbox"/> No		10. Is this well subject to Statewide Rule 36 (hydrogen sulfide area)? <input type="checkbox"/> Yes <input checked="" type="checkbox"/> No			
<b>SURFACE LOCATION AND ACREAGE INFORMATION</b>							
11. RRC District No. <b>7C</b>		12. County <b>UPTON</b>		13. Surface Location <input checked="" type="checkbox"/> Land <input type="checkbox"/> Bay/Estuary <input type="checkbox"/> Inland Waterway <input type="checkbox"/> Offshore			
14. This well is to be located <u>5.72</u> miles in a <u>E</u> direction from <u>Rankin</u> which is the nearest town in the county of the well site.							
15. Section <b>11</b>		16. Block <b>4</b>		17. Survey <b>CCSD&amp;RGNG RR CO</b>		18. Abstract No. <b>A-U47</b>	
				19. Distance to nearest lease line: <b>100</b> ft.		20. Number of contiguous acres in lease, pooled unit, or unitized tract: <b>1315.21</b>	
21. Lease Perpendiculars: <u>1164</u> ft from the <u>W</u> line and <u>432</u> ft from the <u>N</u> line. 22. Survey Perpendiculars: <u>1164</u> ft from the <u>W</u> line and <u>432</u> ft from the <u>N</u> line.							
23. Is this a pooled unit? <input checked="" type="checkbox"/> Yes <input type="checkbox"/> No				24. Unitization Docket No: _____			
25. Are you applying for Substandard Acreage Field? <input type="checkbox"/> Yes (attach Form W-1A) <input checked="" type="checkbox"/> No							
<b>FIELD INFORMATION List all fields of anticipated completion including Wildcat. List one zone per line.</b>							
26. RRC District No.	27. Field No.	28. Field Name (exactly as shown in RRC records)		29. Well Type	30. Completion Depth	31. Distance to Nearest Well in this Reservoir	
7C	85279200	SPRABERRY (TREND AREA)		Oil or Gas Well	8305	676.00	
<b>BOTTOMHOLE LOCATION INFORMATION is required for DIRECTIONAL, HORIZONTAL, AND AMENDED AS DRILLED PERMIT APPLICATIONS (see W-1H attachment)</b>							
<b>Remarks</b> [FILER May 5, 2017 8:37 AM]: Hunt Oil Company recently acquired an additional tract of land that has been added to this lease. Updated acreage and updated lease boundary are reflected on the attached plat and within the W-1.				<b>Certificate:</b> I certify that information stated in this application is true and complete, to the best of my knowledge.  <div style="display: flex; justify-content: space-between;"> <div> <u>Emily DiCarlo, Land/Regulatory Tech</u>            Name of filer  <u>(214)9788197</u>            Phone         </div> <div> <u>May 05, 2017</u>            Date submitted  <u>edicarlo@huntoil.com</u>            E-mail Address (OPTIONAL)         </div> </div>			
<b>RRC Use Only</b> Data Validation Time Stamp: May 15, 2017 3:21 PM( 'As Approved' Version )							

Permit Status:	Approved
<i>The RRC has not approved this application. Duplication or distribution of information is at the user's own risk.</i>	

**RAILROAD COMMISSION OF TEXAS  
OIL & GAS DIVISION**

**APPLICATION FOR PERMIT TO DRILL, RECOMPLETE, OR RE-ENTER**

*This facsimile W-1 was generated electronically from data submitted to the RRC.  
A certification of the automated data is available in the RRC's Austin office.*

Permit #	826301
Approved Date:	May 15, 2017

1. RRC Operator No. 416330	2. Operator's Name (exactly as shown on form P-5, Organization Report) HUNT OIL COMPANY	3. Lease Name UNIVERSITY 3-35	4. Well No. 102HB
<b>Lateral Drainhole Location Information</b>			
5. Field as shown on Form W-1    SPRABERRY (TREND AREA) (Field # 85279200, RRC District 7C)			
6. Section 35	7. Block 4	8. Survey UNIVERSITY LANDS	9. Abstract 35
10. County of BHL UPTON			
11. Terminus Lease Line Perpendiculars 100 ft. from the                      N                      line. and    1006 ft. from the                      W                      line			
12. Terminus Survey Line Perpendiculars 100 ft. from the                      N                      line. and    1006 ft. from the                      W                      line			
13. Penetration Point Lease Line Perpendiculars 100 ft. from the                      S                      line. and    1006 ft. from the                      W                      line			

**RAILROAD COMMISSION OF TEXAS**  
**OIL & GAS DIVISION**

PERMIT TO DRILL, DEEPEN, PLUG BACK, OR RE-ENTER ON A REGULAR OR ADMINISTRATIVE EXCEPTION LOCATION

PERMIT NUMBER <div align="center">826301</div>	DATE PERMIT ISSUED OR AMENDED <div align="center">May 15, 2017</div>	DISTRICT <div align="center">* 7C</div>			
API NUMBER <div align="center">42-461-40592</div>	FORM W-1 RECEIVED <div align="center">May 05, 2017</div>	COUNTY <div align="center">UPTON</div>			
TYPE OF OPERATION <div align="center">NEW DRILL</div>	WELLBORE PROFILE(S) <div align="center">Horizontal</div>	ACRES <div align="center">1315.21</div>			
OPERATOR <div align="center">                     HUNT OIL COMPANY                      1900 NORTH AKARD STREET                      DALLAS, TX 75201-2300                 </div>		NOTICE This permit and any allowable assigned may be revoked if payment for fee(s) submitted to the Commission is not honored. <b>District Office Telephone No:</b> <div align="center">(325) 657-7450</div>			
LEASE NAME <div align="center">UNIVERSITY 3-35</div>		WELL NUMBER <div align="center">102HB</div>			
LOCATION <div align="center">5.72 miles E direction from RANKIN</div>		TOTAL DEPTH <div align="center">8422</div>			
Section, Block and/or Survey SECTION ◀ 11                      BLOCK ◀ 4                      ABSTRACT ◀ U47 SURVEY ◀ CCSD&RGNG RR CO					
DISTANCE TO SURVEY LINES <div align="center">1164 ft. W    432 ft. N</div>		DISTANCE TO NEAREST LEASE LINE <div align="center">100 ft.</div>			
DISTANCE TO LEASE LINES <div align="center">1164 ft. W    432 ft. N</div>		DISTANCE TO NEAREST WELL ON LEASE <div align="center">See FIELD(s) Below</div>			
FIELD(s) and LIMITATIONS: <div align="center">* SEE FIELD DISTRICT FOR REPORTING PURPOSES *</div>					
FIELD NAME LEASE NAME		ACRES NEAREST LEASE	DEPTH NEAREST LEASE	WELL # NEAREST WE	DIST
----- SPRABERRY (TREND AREA) UNIVERSITY 3-35 -----		1315.21 100	8,305	102HB 676	7C
----- WELLBORE PROFILE(s) FOR FIELD: Horizontal -----					
RESTRICTIONS:    Lateral: TH1 Penetration Point Location Lease Lines:            100.0 F S L 1006.0 F W L Terminus Location BH County: UPTON Section: 35                      Block: 4                      Abstract: 35 Survey: UNIVERSITY LANDS Lease Lines:            100.0 F N L 1006.0 F W L Survey Lines:            100.0 F N L 1006.0 F W L					
THE FOLLOWING RESTRICTIONS APPLY TO ALL FIELDS This well shall be completed and produced in compliance with applicable special field or statewide spacing and density rules. If this well is to be used for brine mining, underground storage of liquid hydrocarbons in salt formations, or underground storage of gas in salt formations, a permit for that specific purpose must be obtained from Environmental Services prior to construction, including drilling, of the well in accordance with Statewide Rules 81, 95, and 97.					

**RAILROAD COMMISSION OF TEXAS**  
**OIL & GAS DIVISION**

PERMIT TO DRILL, DEEPEN, PLUG BACK, OR RE-ENTER ON A REGULAR OR ADMINISTRATIVE EXCEPTION LOCATION

PERMIT NUMBER <div style="text-align: right;">826301</div>	DATE PERMIT ISSUED OR AMENDED <div style="text-align: right;">May 15, 2017</div>	DISTRICT <div style="text-align: right;">* 7C</div>										
API NUMBER <div style="text-align: right;">42-461-40592</div>	FORM W-1 RECEIVED <div style="text-align: right;">May 05, 2017</div>	COUNTY <div style="text-align: right;">UPTON</div>										
TYPE OF OPERATION <div style="text-align: right;">NEW DRILL</div>	WELLBORE PROFILE(S) <div style="text-align: right;">Horizontal</div>	ACRES <div style="text-align: right;">1315.21</div>										
OPERATOR <div style="text-align: right;">416330</div> HUNT OIL COMPANY 1900 NORTH AKARD STREET DALLAS, TX 75201-2300		NOTICE This permit and any allowable assigned may be revoked if payment for fee(s) submitted to the Commission is not honored. <b>District Office Telephone No:</b> (325) 657-7450										
LEASE NAME <div style="text-align: right;">UNIVERSITY 3-35</div>		WELL NUMBER <div style="text-align: right;">102HB</div>										
LOCATION <div style="text-align: right;">5.72 miles E direction from RANKIN</div>		TOTAL DEPTH <div style="text-align: right;">8422</div>										
Section, Block and/or Survey SECTION ⚡ 11                      BLOCK ⚡ 4                      ABSTRACT ⚡ U47 SURVEY ⚡ CCSD&RGNG RR CO												
DISTANCE TO SURVEY LINES <div style="text-align: right;">1164 ft. W    432 ft. N</div>		DISTANCE TO NEAREST LEASE LINE <div style="text-align: right;">100 ft.</div>										
DISTANCE TO LEASE LINES <div style="text-align: right;">1164 ft. W    432 ft. N</div>		DISTANCE TO NEAREST WELL ON LEASE <div style="text-align: right;">See FIELD(s) Below</div>										
FIELD(s) and LIMITATIONS: <div style="text-align: center;">* SEE FIELD DISTRICT FOR REPORTING PURPOSES *</div>												
<table style="width: 100%; border: none;"> <tr> <td style="width: 60%;">FIELD NAME</td> <td style="width: 15%;">ACRES</td> <td style="width: 15%;">DEPTH</td> <td style="width: 10%;">WELL #</td> <td style="width: 10%;">DIST</td> </tr> <tr> <td>LEASE NAME</td> <td>NEAREST LEASE</td> <td></td> <td>NEAREST WE</td> <td></td> </tr> </table>			FIELD NAME	ACRES	DEPTH	WELL #	DIST	LEASE NAME	NEAREST LEASE		NEAREST WE	
FIELD NAME	ACRES	DEPTH	WELL #	DIST								
LEASE NAME	NEAREST LEASE		NEAREST WE									
This well must comply to the new SWR 3.13 requirements concerning the isolation of any potential flow zones and zones with corrosive formation fluids. See approved permit for those formations that have been identified for the county in which you are drilling the well in.												

**RAILROAD COMMISSION OF TEXAS  
OIL & GAS DIVISION  
SWR #13 Formation Data**

**UPTON (461) County**

Formation	Shallow Top	Deep Top	Remarks	Geological Order	Effective Date
YATES	1,100	1,200		1	12/17/2013
GRAYBURG	1,600	3,000		2	12/17/2013
SAN ANDRES	2,500	3,500	saltwater flow	3	12/17/2013
SPRABERRY	4,500	7,000		4	12/17/2013
WOLFCAMP	7,500	9,900		5	12/17/2013
STRAWN	7,900	9,800		6	12/17/2013
DEVONIAN	6,300	12,000		7	12/17/2013
FUSSELMAN	11,000	12,100		8	12/17/2013
ELLENBURGER	7,900	12,400		9	12/17/2013

The above list may not be all inclusive, and may also include formations that do not intersect all wellbores. Formation "TOP" information listed reflects an estimated range based on geologic variances across the county. To clarify, the "Deep Top" is not the bottom of the formation; it is the deepest depth at which the "TOP" of the formation has been or might be encountered. This is a dynamic list subject to updates and revisions. It is the operator's responsibility to make sure that at the time of spudding the well the most current list is being referenced. Refer to the RRC website at the following address for the most recent information.  
<http://www.rrc.texas.gov/oil-gas/compliance-enforcement/rule-13-geologic-formation-info>

## GROUNDWATER PROTECTION DETERMINATION

Form GW-2



## Groundwater Advisory Unit

**Date Issued:** 04 May 2017**GAU Number:** 171437**Attention:** HUNT OIL COMPANY  
1900 NORTH AKARD STREET  
DALLAS, TX 75201**API Number:** 46140581  
**County:** UPTON  
**Lease Name:** UNIVERSITY 3-35**Operator No.:** 416330**Lease Number:**  
**Well Number:** 4HB  
**Total Vertical Depth:** 8422  
**Latitude:** 31.200855  
**Longitude:** -101.855609  
**Datum:** NAD27**Purpose:** New Drill**Location:** Survey-UL; Block-4; Section-11

To protect usable-quality groundwater at this location, the Groundwater Advisory Unit of the Railroad Commission of Texas recommends:

The interval from the land surface to 20 feet below the base of the Cretaceous-age beds must be protected. The base of the Cretaceous is estimated to occur at a depth of 550 feet.

This recommendation is applicable for all wells drilled in this N/2 of sec. 11.

Note: Unless stated otherwise, this recommendation is intended to apply only to the subject well and not for area-wide use. This recommendation is for normal drilling, production, and plugging operations only. It does not apply to saltwater disposal operation into a nonproductive zone (RRC Form W-14).

This determination is based on information provided when the application was submitted on 05/04/2017. If the location information has changed, you must contact the Groundwater Advisory Unit, and submit a new application if necessary. If you have questions, please contact us at 512-463-2741 or gau@rrc.texas.gov.

Groundwater Advisory Unit, Oil and Gas Division

Form GW-2 P.O. Box 12967 Austin, Texas 78771-2967 512-463-2741 Internet address: www.rrc.texas.gov  
Rev. 02/2014

HUNT OIL COMPANY  
UNIVERSITY 3-35 102HB  
BOTTOM HOLE LOCATION  
(LAST TAKE POINT)

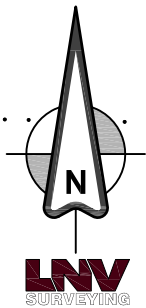

1006'  
100'  
676'  
103HB BHL (LTP)  
104HB BHL (LTP)  
1HB BHL  
1HB LTP  
SURVEY & LEASE LINE

W 1/2  
OF NW 1/4  
SECTION 35

**1,315.21 ACRE  
LEASE SHOWN**

UL  
A-U36  
SEC.36  
BLK. 3

UL  
A-U35  
SEC. 35  
BLK. 3

UL  
A-U34  
SEC.34  
BLK. 3

DETAIL 'A'  
NOT TO SCALE

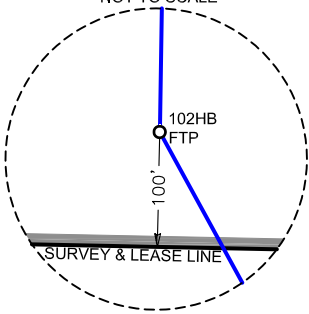

UNIVERSITY 3-35 #102HB LATERAL

UNIVERSITY 3-35# 103HB LATERAL

UNIVERSITY 3-35# 104HB LATERAL

UNIVERSITY 3-35 #1HB LATERAL

TRACT 1  
654.79 ACRES

TRACT 2  
660.42 ACRES

TRACT & SURVEY LINE

UL  
A-U37  
SEC. 1  
BLK. 4

UL  
A-U38  
SEC. 2  
BLK. 4

UL  
A-U39  
SEC. 3  
BLK. 4

DRY HOLE  
#1

LINE	BEARING	DISTANCE
L1	N 15°25'10" W	554.59'
L2	N 01°09'57" E	10427.12'

DETAIL 'B'  
NOT TO SCALE

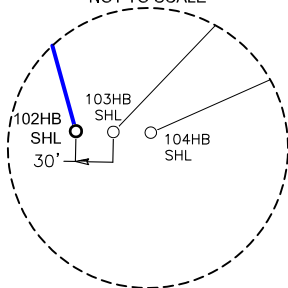

HUNT OIL COMPANY  
UNIVERSITY 3-35 102HB  
POINT OF PENETRATION  
(FIRST TAKE POINT)

SEE DETAIL 'A'

103HB POP (FTP)

104HB POP (FTP)

SURVEY & LEASE LINE

500 0 500 1000

SCALE: 1" = 1000 FEET

NOTE: COORDINATES SHOWN ARE BASED ON  
NAD27 TEXAS STATE PLANE COORDINATE  
SYSTEM, TEXAS CENTRAL ZONE.

I HEREBY STATE THAT THIS PLAT SHOWS  
THE SUBJECT LOCATION AS STAKED ON  
THE GROUND 2/22/17. THIS SHOULD  
NOT BE CONSIDERED A BOUNDARY  
SURVEY.

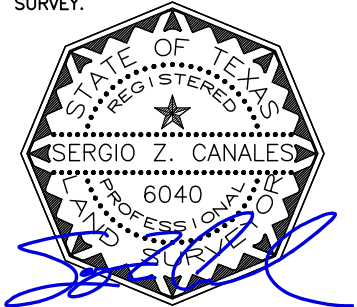

SERGIO Z. CANALES  
REGISTERED PROFESSIONAL LAND SURVEYOR  
LICENSE NO. 6040

**HUNT OIL COMPANY**

UL  
A-U47  
SEC. 11  
BLK. 4

UL  
A-U46  
SEC. 10  
BLK. 4

	LEASE CALLS	SURVEY CALLS	GND ELEV.	NAD27 TEXAS STATE PLANE COORDINATES	NAD27 GEOGRAPHIC COORDINATES(DMS)	NAD27 GEOGRAPHIC COORDINATES(DD)	NAD83 GEOGRAPHIC COORDINATES(DD)
102HB SHL	OFF LEASE 432' FNL	1,164' FWL 432' FNL	2,706.6'	Y = 561,220 X = 1,524,021	LAT. = 31°12'03.08" N LONG. = 101°51'20.88" W	LAT. = 31.2008569° N LONG. = 101.8558008° W	LAT. = 31.2010069° N LONG. = 101.8562061° W
102HB POP(FTP)	1,006' FWL 100' FSL	1,006' FWL 100' FSL	- - -	Y = 561,754 X = 1,523,874	LAT. = 31°12'08.36" N LONG. = 101°51'22.66" W	LAT. = 31.2023212° N LONG. = 101.8562958° W	- - -
102HB BHL(LTP)	1,006' FWL 100' FNL	1,006' FWL 100' FNL	- - -	Y = 572,179 X = 1,524,086	LAT. = 31°13'51.56" N LONG. = 101°51'21.87" W	LAT. = 31.2309898° N LONG. = 101.8560738° W	- - -

A WELL LOCATION PLAT FOR:

**HUNT OIL COMPANY**

**UNIVERSITY 3-35 102HB**

SITUATED IN THE UNIVERSITY LAND SURVEYS, A-U35, SECTION 35 BLOCK 3, A-U38, SECTION 2,  
BLOCK 4, AND A-U47, SECTION 11, BLOCK 4, APPROXIMATELY 5.72 MILES EAST OF RANKIN IN  
UPTON COUNTY, TEXAS.

Survey Date: 05/04/17

Surveyed By: RM/MG

Drawn by: MC

Checked by: HR/SS

Job #: 140241.153



engineers | architects | surveyors

801 NAVIGATION, SUITE 300  
CORPUS CHRISTI, TX 78408

PH. (361) 883-1984  
FAX (361) 883-1986

WWW.LNVINC.COM

TBPE FIRM NO. F-366  
TBPLS FIRM NO. 10125500

PLOT DATE: 05-04-17 4:31 PM

U:\Hunt Oil\140241 MSA\153 University 2 35 20 102HB Upton County\Drawings\140241.153-University 3-35 102HB WL.dwg