

| | | | | | | | |
|---|---------------|--|----------------------------------|--|----------------------|---|--|
| API No. <u>42-383-39830</u> Drilling Permit # <u>824287</u> SWR Exception Case/Docket No. _____ | | RAILROAD COMMISSION OF TEXAS OIL & GAS DIVISION APPLICATION FOR PERMIT TO DRILL, RECOMPLETE, OR RE-ENTER <i>This facsimile W-1 was generated electronically from data submitted to the RRC.</i> <i>A certification of the automated data is available in the RRC's Austin office.</i> | | | | FORM W-1 07/2004 Permit Status: Approved | |
| 1. RRC Operator No. 655836 | | 2. Operator's Name (as shown on form P-5, Organization Report) PERMIAN RESOURCES, LLC | | 3. Operator Address (include street, city, state, zip): PO BOX 14670 OKLAHOMA CITY, OK 73113-0000 | | | |
| 4. Lease Name UNIVERSITY 11 RE | | 5. Well No. 931HS | | | | | |
| GENERAL INFORMATION | | | | | | | |
| 6. Purpose of filing (mark ALL appropriate boxes): <input checked="" type="checkbox"/> New Drill <input type="checkbox"/> Recompletion <input type="checkbox"/> Reclass <input type="checkbox"/> Field Transfer <input type="checkbox"/> Re-Enter <input type="checkbox"/> Amended <input type="checkbox"/> Amended as Drilled (BHL) (Also File Form W-1D) | | | | | | | |
| 7. Wellbore Profile (mark ALL appropriate boxes): <input type="checkbox"/> Vertical <input checked="" type="checkbox"/> Horizontal (Also File Form W-1H) <input type="checkbox"/> Directional (Also File Form W-1D) <input type="checkbox"/> Sidetrack | | | | | | | |
| 8. Total Depth 7600 | | 9. Do you have the right to develop the minerals under any right-of-way ? <input checked="" type="checkbox"/> Yes <input type="checkbox"/> No | | 10. Is this well subject to Statewide Rule 36 (hydrogen sulfide area)? <input type="checkbox"/> Yes <input checked="" type="checkbox"/> No | | | |
| SURFACE LOCATION AND ACREAGE INFORMATION | | | | | | | |
| 11. RRC District No. 7C | | 12. County REAGAN | | 13. Surface Location <input checked="" type="checkbox"/> Land <input type="checkbox"/> Bay/Estuary <input type="checkbox"/> Inland Waterway <input type="checkbox"/> Offshore | | | |
| 14. This well is to be located <u>2.97</u> miles in a <u>NW</u> direction from <u>Big Lake</u> which is the nearest town in the county of the well site. | | | | | | | |
| 15. Section 33 | | 16. Block 10 | | 17. Survey UNIVERSITY LANDS | | 18. Abstract No. A- | |
| | | | | 19. Distance to nearest lease line: 100 ft. | | 20. Number of contiguous acres in lease, pooled unit, or unitized tract: 3214.83 | |
| 21. Lease Perpendiculars: <u>549</u> ft from the <u>SOUTH</u> line and <u>547</u> ft from the <u>EAST</u> line. 22. Survey Perpendiculars: <u>549</u> ft from the <u>SOUTH</u> line and <u>547</u> ft from the <u>EAST</u> line. | | | | | | | |
| 23. Is this a pooled unit? <input checked="" type="checkbox"/> Yes <input type="checkbox"/> No | | | 24. Unitization Docket No: _____ | | | | |
| 25. Are you applying for Substandard Acreage Field? <input type="checkbox"/> Yes (attach Form W-1A) <input checked="" type="checkbox"/> No | | | | | | | |
| FIELD INFORMATION List all fields of anticipated completion including Wildcat. List one zone per line. | | | | | | | |
| 26. RRC District No. | 27. Field No. | 28. Field Name (exactly as shown in RRC records) | | 29. Well Type | 30. Completion Depth | 31. Distance to Nearest Well in this Reservoir | |
| 7C | 53613750 | LIN (WOLFCAMP) | | Oil or Gas Well | 7600 | 1.00 | |
| | | | | | | | |
| | | | | | | | |
| | | | | | | | |
| BOTTOMHOLE LOCATION INFORMATION is required for DIRECTIONAL, HORIZONTAL, AND AMENDED AS DRILLED PERMIT APPLICATIONS (see W-1H attachment) | | | | | | | |
| Remarks [RRC STAFF Mar 20, 2017 9:44 AM]: Removed lease line exception as per field rules. | | | | Certificate: I certify that information stated in this application is true and complete, to the best of my knowledge. <u>Rena Carter, Sr. Regulatory Specialist</u> <u>Mar 09, 2017</u> Name of filer Date submitted <u>(405)9684450</u> <u>rena.carter@permianresources.com</u> Phone E-mail Address (OPTIONAL) | | | |
| RRC Use Only Data Validation Time Stamp: Mar 20, 2017 2:16 PM(Current Version) | | | | | | | |

| |
|---|
| Permit Status: Approved <i>The RRC has not approved this application. Duplication or distribution of information is at the user's own risk.</i> |
|---|

**RAILROAD COMMISSION OF TEXAS
OIL & GAS DIVISION**

APPLICATION FOR PERMIT TO DRILL, RECOMPLETE, OR RE-ENTER

*This facsimile W-1 was generated electronically from data submitted to the RRC.
 A certification of the automated data is available in the RRC's Austin office.*

| | |
|------------------------------------|---------------|
| Permit # | 824287 |
| Approved Date: Mar 20, 2017 | |

| | | | |
|---|---|--|-----------------------------|
| 1. RRC Operator No. 655836 | 2. Operator's Name (exactly as shown on form P-5, Organization Report) PERMIAN RESOURCES, LLC | 3. Lease Name UNIVERSITY 11 RE | 4. Well No. 931HS |
| Lateral Drainhole Location Information | | | |
| 5. Field as shown on Form W-1 LIN (WOLFCAMP) (Field # 53613750, RRC District 7C) | | | |
| 6. Section 9 | 7. Block 11 | 8. Survey UNIVERSITY LANDS | 9. Abstract |
| | | 10. County of BHL REAGAN | |
| 11. Terminus Lease Line Perpendiculars 15 ft. from the south line. and 986 ft. from the East line | | | |
| 12. Terminus Survey Line Perpendiculars 15 ft. from the south line. and 986 ft. from the east line | | | |
| 13. Penetration Point Lease Line Perpendiculars 15 ft. from the north line. and 985 ft. from the east line | | | |

RAILROAD COMMISSION OF TEXAS
OIL & GAS DIVISION

PERMIT TO DRILL, DEEPEN, PLUG BACK, OR RE-ENTER ON A REGULAR OR ADMINISTRATIVE EXCEPTION LOCATION

| | | | |
|--|--|--|--------------------------|
| PERMIT NUMBER 824287 | DATE PERMIT ISSUED OR AMENDED Mar 20, 2017 | DISTRICT * 7C | |
| API NUMBER 42-383-39830 | FORM W-1 RECEIVED Mar 09, 2017 | COUNTY REAGAN | |
| TYPE OF OPERATION NEW DRILL | WELLBORE PROFILE(S) Horizontal | ACRES 3214.83 | |
| OPERATOR PERMIAN RESOURCES, LLC PO BOX 14670 OKLAHOMA CITY, OK 73113-0000 | | NOTICE This permit and any allowable assigned may be revoked if payment for fee(s) submitted to the Commission is not honored. District Office Telephone No: (325) 657-7450 | |
| LEASE NAME UNIVERSITY 11 RE | | WELL NUMBER 931HS | |
| LOCATION 2.97 miles NW direction from BIG LAKE | | TOTAL DEPTH 7600 | |
| Section, Block and/or Survey SECTION 33 BLOCK 10 ABSTRACT 1 SURVEY UNIVERSITY LANDS | | | |
| DISTANCE TO SURVEY LINES 549 ft. SOUTH 547 ft. EAST | | DISTANCE TO NEAREST LEASE LINE 100 ft. | |
| DISTANCE TO LEASE LINES 549 ft. SOUTH 547 ft. EAST | | DISTANCE TO NEAREST WELL ON LEASE See FIELD(s) Below | |
| FIELD(s) and LIMITATIONS: <p align="center">* SEE FIELD DISTRICT FOR REPORTING PURPOSES *</p> | | | |
| FIELD NAME LEASE NAME | | ACRES NEAREST LEASE | DEPTH NEAREST LEASE |
| ----- LIN (WOLFCAMP) UNIVERSITY 11 RE ----- | | 3214.83 100 | 7,600 1 |
| ----- WELLBORE PROFILE(s) FOR FIELD: Horizontal ----- | | | |
| RESTRICTIONS: Lateral: TH1 Penetration Point Location Lease Lines: 15.0 F NORTH L 985.0 F EAST L Terminus Location BH County: REAGAN Section: 9 Block: 11 Abstract: Survey: UNIVERSITY LANDS Lease Lines: 15.0 F SOUTH L 986.0 F EAST L Survey Lines: 15.0 F SOUTH L 986.0 F EAST L | | | |
| <p align="center">THE FOLLOWING RESTRICTIONS APPLY TO ALL FIELDS</p> <p>This well shall be completed and produced in compliance with applicable special field or statewide spacing and density rules. If this well is to be used for brine mining, underground storage of liquid hydrocarbons in salt formations, or underground storage of gas in salt formations, a permit for that specific purpose must be obtained from Environmental Services prior to construction, including drilling, of the well in accordance with Statewide Rules 81, 95, and 97.</p> | | | |

RAILROAD COMMISSION OF TEXAS
OIL & GAS DIVISION

PERMIT TO DRILL, DEEPEN, PLUG BACK, OR RE-ENTER ON A REGULAR OR ADMINISTRATIVE EXCEPTION LOCATION

| | | |
|---|---|---|
| PERMIT NUMBER <div style="text-align: right;">824287</div> | DATE PERMIT ISSUED OR AMENDED <div style="text-align: center;">Mar 20, 2017</div> | DISTRICT <div style="text-align: center;">* 7C</div> |
| API NUMBER <div style="text-align: right;">42-383-39830</div> | FORM W-1 RECEIVED <div style="text-align: center;">Mar 09, 2017</div> | COUNTY <div style="text-align: center;">REAGAN</div> |
| TYPE OF OPERATION <div style="text-align: center;">NEW DRILL</div> | WELLBORE PROFILE(S) <div style="text-align: center;">Horizontal</div> | ACRES <div style="text-align: center;">3214.83</div> |
| OPERATOR <div style="text-align: right;">655836</div> <div style="text-align: center;">PERMIAN RESOURCES, LLC</div> <div style="text-align: center;">PO BOX 14670</div> <div style="text-align: center;">OKLAHOMA CITY, OK 73113-0000</div> | | NOTICE This permit and any allowable assigned may be revoked if payment for fee(s) submitted to the Commission is not honored. District Office Telephone No: <div style="text-align: center;">(325) 657-7450</div> |
| LEASE NAME <div style="text-align: center;">UNIVERSITY 11 RE</div> | | WELL NUMBER <div style="text-align: center;">931HS</div> |
| LOCATION <div style="text-align: center;">2.97 miles NW direction from BIG LAKE</div> | | TOTAL DEPTH <div style="text-align: center;">7600</div> |
| Section, Block and/or Survey <div style="display: flex; justify-content: space-between;"> <div>SECTION 33</div> <div>BLOCK 10</div> <div>ABSTRACT </div> </div> <div style="text-align: center;">SURVEY UNIVERSITY LANDS</div> | | |
| DISTANCE TO SURVEY LINES <div style="text-align: center;">549 ft. SOUTH 547 ft. EAST</div> | | DISTANCE TO NEAREST LEASE LINE <div style="text-align: center;">100 ft.</div> |
| DISTANCE TO LEASE LINES <div style="text-align: center;">549 ft. SOUTH 547 ft. EAST</div> | | DISTANCE TO NEAREST WELL ON LEASE <div style="text-align: center;">See FIELD(s) Below</div> |
| FIELD(s) and LIMITATIONS: <div style="text-align: center;">* SEE FIELD DISTRICT FOR REPORTING PURPOSES *</div> | | |
| <div style="display: flex; justify-content: space-between;"> <div> FIELD NAME LEASE NAME </div> <div> ACRES NEAREST LEASE </div> <div> DEPTH NEAREST LEASE </div> <div> WELL # NEAREST WE </div> <div> DIST </div> </div> | | |
| <p>This well must comply to the new SWR 3.13 requirements concerning the isolation of any potential flow zones and zones with corrosive formation fluids. See approved permit for those formations that have been identified for the county in which you are drilling the well in.</p> <p>This is a non-contiguous lease. All acreage assigned must be contiguous.</p> | | |

**RAILROAD COMMISSION OF TEXAS
OIL & GAS DIVISION
SWR #13 Formation Data**

REAGAN (383) County

| Formation | Shallow Top | Deep Top | Remarks | Geological Order | Effective Date |
|-------------|----------------|-------------|--------------------------------|---------------------|-------------------|
| GRAYBURG | 1,500 | 2,500 | | 1 | 12/17/2013 |
| QUEEN | 1,900 | 2,500 | | 2 | 12/17/2013 |
| SAN ANDRES | 2,000 | 5,000 | saltwater flow, possibly heavy | 3 | 12/17/2013 |
| CLEARFORK | 3,300 | 4,000 | | 4 | 12/17/2013 |
| SPRABERRY | 3,300 | 10,000 | | 5 | 12/17/2013 |
| STRAWN | 9,300 | 10,200 | | 6 | 12/17/2013 |
| FUSSELMAN | 8,800 | 11,000 | | 7 | 12/17/2013 |
| ELLENBURGER | 8,700 | 10,500 | | 8 | 12/17/2013 |

The above list may not be all inclusive, and may also include formations that do not intersect all wellbores. Formation "TOP" information listed reflects an estimated range based on geologic variances across the county. To clarify, the "Deep Top" is not the bottom of the formation; it is the deepest depth at which the "TOP" of the formation has been or might be encountered. This is a dynamic list subject to updates and revisions. It is the operator's responsibility to make sure that at the time of spudding the well the most current list is being referenced. Refer to the RRC website at the following address for the most recent information.
<http://www.rrc.texas.gov/oil-gas/compliance-enforcement/rule-13-geologic-formation-info>

GROUNDWATER PROTECTION DETERMINATION

Form GW-2



Groundwater Advisory Unit

Date Issued: 17 March 2017**GAU Number:** 169038**Attention:** PERMIAN RESOURCES, LLC
PO BOX 14670
OKLAHOMA CITY, OK 73113**Operator No.:** 655836**API Number:** 38339829
County: REAGAN
Lease Name: University 11 RE
Lease Number:
Well Number: 932HA
Total Vertical Depth: 9000
Latitude: 31.215619
Longitude: -101.502487
Datum: NAD27**Purpose:** New Drill**Location:** Survey-UL; Block-10; Section-33

To protect usable-quality groundwater at this location, the Groundwater Advisory Unit of the Railroad Commission of Texas recommends:

The interval from the land surface to the base of the Santa Rosa, which is estimated to occur at a depth between 800 and 850 feet, must be protected.

This recommendation is applicable for all wells drilled in this SE/4 of sec. 33.

Note: Unless stated otherwise, this recommendation is intended to apply only to the subject well and not for area-wide use. This recommendation is for normal drilling, production, and plugging operations only. It does not apply to saltwater disposal operation into a nonproductive zone (RRC Form W-14).

This determination is based on information provided when the application was submitted on 03/16/2017. If the location information has changed, you must contact the Groundwater Advisory Unit, and submit a new application if necessary. If you have questions, please contact us at 512-463-2741 or gau@rrc.texas.gov.

Groundwater Advisory Unit, Oil and Gas Division

Form GW-2 P.O. Box 12967 Austin, Texas 78771-2967 512-463-2741 Internet address: www.rrc.texas.gov
Rev. 02/2014

NAD 27, Central Zone 4203

Surface Hole Location (Sec. 33)

Latitude: 31.215619° N

Longitude: 101.502423° W

X=1634551.51

Y=565251.81

Elev.=2666'

549' FSL & 547' FEL

Point of Penetration (Sec. 4)

Latitude: 31.214081° N

Longitude: 101.503842° W

X=1634102.21

Y=564696.83

15' FNL & 985' FEL

First Take Point (Sec. 4)

Latitude: 31.213847° N

Longitude: 101.503844° W

X=1634100.48

Y=564611.85

100' FNL & 985' FEL

Last Take Point (Sec. 9)

Latitude: 31.185251° N

Longitude: 101.504172° W

X=1633888.62

Y=554213.19

100' FSL & 986' FEL

Bottom Hole Location (Sec. 9)

Latitude: 31.185017° N

Longitude: 101.504175° W

X=1633886.88

Y=554128.20

15' FSL & 986' FEL

Unit Boundary Distance

| SHL | Out Of Unit |
|-----|---------------------|
| PP | 15' FNL & 985' FEL |
| FTP | 100' FNL & 985' FEL |
| LTP | 100' FSL & 986' FEL |
| BHL | 15' FSL & 986' FEL |

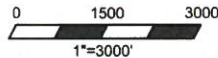

NOTE: This Plat does not, in anyway represent a "Boundary Survey", and does not comply with the current T.B.P.L.S. Minimum Standards of Procedures for Boundary Survey. Acreage shown herein were furnished by others. The information contained on this plat is intended for the sole use of PERMIAN RESOURCES, LLC.

NOTE: Bearings and coordinates refer to the Texas Coordinate System of 1927, Central Zone (4203), as observed by GPS observations

I, Damian M. Jagers do hereby certify that the above described well location was surveyed on the ground under my supervision, as shown.

Damian M. Jagers 2/28/2017
DATE

Damian M. Jagers
REGISTERED PROFESSIONAL LAND SURVEYOR
TEXAS REGISTRATION NO. 6269



Well Name
UNIVERSITY 11 RE 931HS

Drilling Field
LIN (WOLFCAMP) FIELD

Nearest Town

2.97 MILES NORTHWEST OF BIG LAKE, TEXAS

University Lands
Block 11, Sec. 1

University Lands
Block 11, Sec. 2

University Lands
Block 11, Sec. 3

University Lands
Block 11, Sec. 4

University Lands
Block 11, Sec. 5

University Lands
Block 11, Sec. 6

University Lands
Block 11, Sec. 12

University Lands
Block 11, Sec. 11

University Lands
Block 11, Sec. 14

University Lands
Block 11, Sec. 15

University Lands
Block 11, Sec. 16

University Lands
Block 11, Sec. 17

University Lands
Block 11, Sec. 18

University Lands
Block 10, Sec. 35

University Lands
Block 10, Sec. 34

University Lands
Block 10, Sec. 33

University Lands
Block 10, Sec. 32

University Lands
Block 10, Sec. 31

X=1624534.44
Y=564904.00

Found Concrete Marker

X=1619150.83
Y=559712.31

X=1624426.51
Y=559606.21

X=1619097.07
Y=557063.29

X=1624372.54
Y=556957.32

X=1624318.57
Y=554308.42

SHL 549'
PP 547'
FTP 428'
X=1635087.59
Y=564692.04
Found Disturbed Concrete Marker

LTP 986'
BHL 986'
X=1634872.32
Y=554093.10

| Tract | Lessor | Called Acreage | % of Total |
|-------|------------------|-----------------|------------|
| 1 | University Lands | 320.3750 Acres | 9.9656 |
| 2 | University Lands | 641.5000 Acres | 19.9544 |
| 3 | University Lands | 641.5000 Acres | 19.9544 |
| 4 | University Lands | 641.5000 Acres | 19.9544 |
| 5 | University Lands | 641.5000 Acres | 19.9544 |
| 6 | University Lands | 328.4500 Acres | 10.2168 |
| Total | | 3214.8250 Acres | 100.0000 |

3214.825 Acres
UNIVERSITY 11 RE UNIT

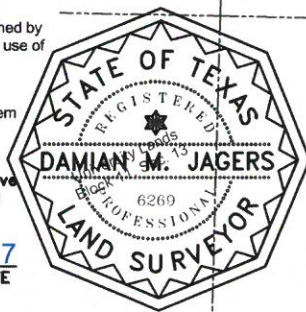

1503 Dartmouth St. Longview, TX 75601
Phone: 254-965-8585
email: cross@xtssurveying.com
web: www.xtssurveying.net

| | |
|-------------|--------------|
| Draft Date | 12-13-16 |
| Drawn By | D. Jagers |
| Revised By | |
| Reviewed By | B. Weisinger |

Well Plat
For
Permian Resources, LLC

University 11 RE 931HS
University Lands Block 11, Section 4
University Lands Block 11, Section 9
University Lands Block 11, Section 3
University Lands Block 11, Section 15
University Lands Block 11, Section 10
University Lands Block 11, Section 11
University Lands Block 11, Section 7
Reagan County, Texas